



PROPRIETARY ITEM - EXCEPT FOR USES EXPRESSLY GRANTED IN WRITING INFORMATION DISCLOSED HEREON IS CONFIDENTIAL AND ALL RIGHTS PATENT AND OTHERWISE ARE RESERVED BY SOUTHCO, INC.

52 CAPTIVE SCREW ASSEMBLY,
PRESS-IN STYLE, KNURLED HEAD, M3 THREAD

DATE	DRAWN	CHKD	SCALE	DRAWING NUMBER
07FEB2002	AJH	TVA	3:1	J-52-3-10

REV	DATE	DRAWN/CHKD	DESCRIPTION	PART NUMBER	MATERIAL AND FINISH	P-1	P-2
A	16APR2002	TVA/AJH	PRN: P2002-0215 (RELEASED)	52-37-51-4	SEE NOTE B	0.9	5.3
B	22MAY2002	JTG/TVA	PRN: P2002-0301	52-37-53-4	SEE NOTE B	2.5	6.8
C	11NOV2003	LTS/MJS	PRN: P2003-1024	52-39-51-4	SEE NOTE B	0.9	5.3
D	22AUG2006	MJS/JSS	PRN: P2006-1137	52-39-53-4	SEE NOTE B	2.5	6.8
E	05JUL2016	CMS/CDW	PRN: P2016-1559				

MILLIMETERS

ALL DIMENSIONS WITHOUT TOLERANCES ARE FOR REFERENCE ONLY.

THIRD ANGLE PROJECTION

A4 PAPER SIZE

T15 TORX®/SLOT RECESS (52-37-5X-4)

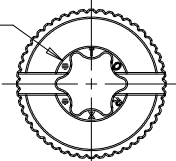

NUMBER 2 PHILLIPS/SLOT RECESS (52-39-5X-4)

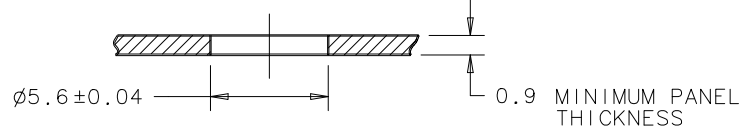
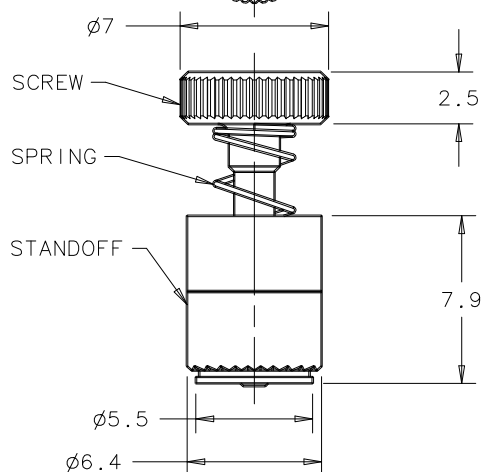
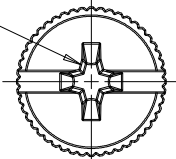

PANEL PREPARATION

NOTES:

- A. RoHS COMPLIANT.
- B. SCREW: STEEL, HARDENED, ZINC PLATE, CHROMATE PLUS SEALER
SPRING: 302 STAINLESS STEEL, PASSIVATED
STANDOFF: STEEL, ZINC PLATE, CHROMATE PLUS SEALER
- C. FOR A ZINC PLATE, BLACK CHROMATE PLUS SEALER ASSEMBLY ADD A -5 INSTEAD OF A -4 TO THE PART NUMBER (EXAMPLE: 52-39-53-5).
- D. INSTALLATION INSTRUCTIONS:
 1. PREPARE HOLE IN THE PANEL AS SHOWN. OUTSIDE EDGE MUST BE SHARP; DO NOT CHAMFER.
 2. PUNCH SURFACE AND BACK-UP TOOL SURFACE MUST REMAIN PARALLEL DURING INSTALLATION. A HARDENED STEEL BACK-UP TOOL WITH A CLEARANCE HOLE AS SHOWN, IS RECOMMENDED.
 3. PRESS THE ASSEMBLY INTO THE PANEL UNTIL ONLY THE TOP OF THE KNURL ON THE STANDOFF IS VISIBLE. RECOMMENDED LOAD OF 10,000 N FOR STEEL, $R_B < 60$ MAX. RECOMMENDED LOAD OF 5,500 N FOR 5052-H32 ALUMINUM.
- E. TORX IS A REGISTERED TRADEMARK OF ACUMENT® INTELLECTUAL PROPERTIES, LLC.
- F. RECOMMENDED MAXIMUM TIGHTENING TORQUE OF 60 N-cm.

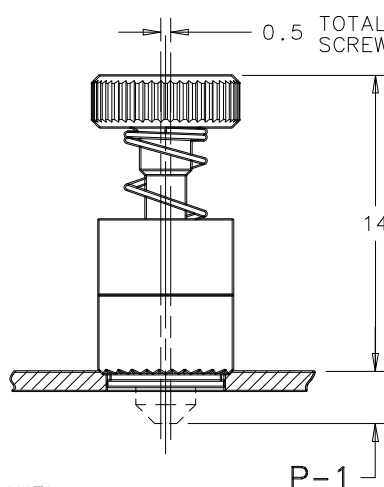

UNFASTENED

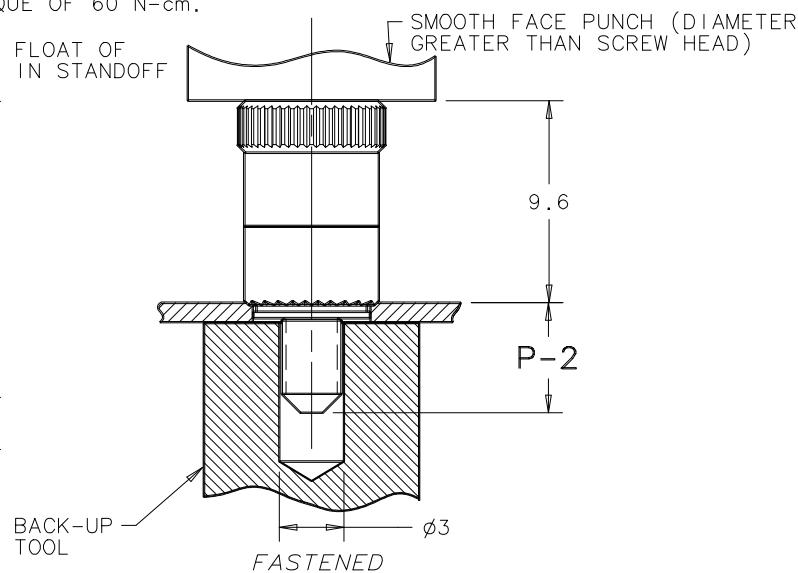

FASTENED